

CMMSH1-40L

LOW V_F SURFACE MOUNT
SILICON SCHOTTKY RECTIFIER
1.0 AMP, 40 VOLTS



SOD-123F CASE

MARKING CODE: CS40FL

FEATURES:

- High Current (1.0A Max), 40V Device
- Low V_F (0.45V Max)
- High Surge Current 50A
- Thermally efficient SOD-123F Flat Lead package design

MAXIMUM RATINGS: ($T_J=25^\circ\text{C}$ unless otherwise noted)

	SYMBOL		UNITS
Peak Repetitive Reverse Voltage	V_{RRM}	40	V
DC Blocking Voltage	V_R	40	V
Average Forward Current	I_O	1.0	A
Peak Forward Surge Current	I_{FSM}	50	A
Power Dissipation (Note 1)	P_D	550	mW
Operating Junction Temperature Range	T_J	-55 to + 125	$^\circ\text{C}$
Storage Temperature Range	T_{stg}	-55 to + 150	$^\circ\text{C}$
Thermal Resistance	θ_{JA}	181	$^\circ\text{C}/\text{W}$

Notes: (1) FR-5 board (1.0 x 0.75 x 0.062 in) with copper mounting pad area of 2.9mm²

ELECTRICAL CHARACTERISTICS: ($T_J=25^\circ\text{C}$ unless otherwise noted)

SYMBOL	TEST CONDITIONS	MIN	TYP	MAX	UNITS
BV_R	$I_R=0.5\text{mA}$	40			V
I_R	$V_R=20\text{V}$		3.0	150	μA
I_R	$V_R=40\text{V}$		10	500	μA
I_R	$V_R=40\text{V}, T_J=85^\circ\text{C}$			25	mA
V_F	$I_F=1.0\text{A}$		0.4	0.45	V
C_T	$V_R=10\text{V}, f=1.0\text{MHz}$		70		pF

DESCRIPTION:

The Central Semiconductor Corp. CMMSH1-40L is a 1.0A, Low V_F , Silicon Schottky Rectifier. This high efficiency, Low V_F Schottky features high current capacity packaged in a small, thermally efficient, SOD-123F surface mount package. When compared to similar devices in the larger SMA package, this device is 58% smaller, with a 67% lower profile, making it ideally suited for applications where performance and size are critical.

APPLICATIONS:

- DC / DC Converters
- Voltage Clamping
- Protection Circuits
- Battery powered applications including Cell Phones, Digital Cameras, Pagers, PDA's, Laptop Computers, etc.

SOD-123F CASE - MECHANICAL OUTLINE

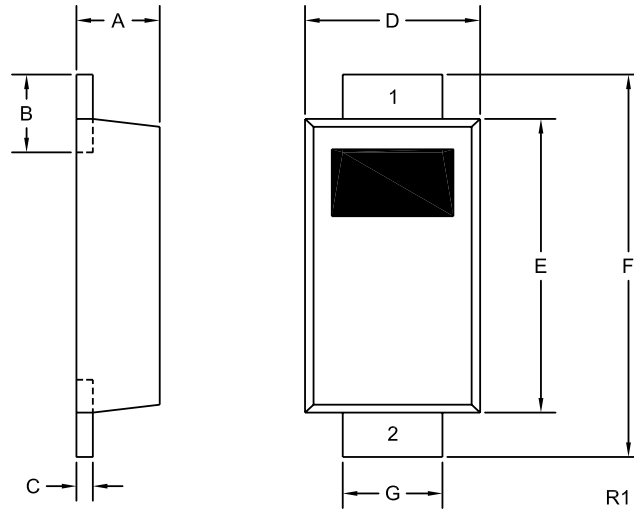

DIMENSIONS				
SYMBOL	INCHES		MILLIMETERS	
	MIN	MAX	MIN	MAX
A	0.035	0.043	0.88	1.08
B	0.020	0.031	0.50	0.80
C	0.004	0.008	0.10	0.20
D	0.065	0.077	1.65	1.95
E	0.104	0.116	2.65	2.95
F	0.140	0.156	3.55	3.95
G	0.030	0.041	0.75	1.05

SOD-123F (REV:R1)

LEAD CODE:

- 1) CATHODE
- 2) ANODE

MARKING CODE: CS40FL